

PAK® 200i

MANUAL AIR-PLASMA CUTTING & GOUGING SYSTEM

200 amps of Cutting Power – This unit is capable of hand cutting at 200 amps with the ability to cut up to 2-3/4" (70 mm) on Mild Steel. At full output this unit will cut 10 ipm (254 mm/min) on 2" (51 mm) carbon steel.

100% Duty Cycle – This machine offers 100% duty cycle at full output.

Dual Gas Capability – The dual gas system ensures superior quality and performance on ferrous and non-ferrous materials. (Plasma Gas: Air, ArH₂ Secondary Gas: Air, N₂)

High Gouging Removal Rate – With the ability to remove up to 25 lbs (11.3 kg) of carbon steel per hour.

Tip Saver for Optimal Tip Life – This ensures that any accidental contact between the tip and the work at high power levels will not damage the tip.

PERFORMANCE

- Output Current - 35-200 amps
- Output Power - 40 kW
- Recommended Cut - 1-1/2" (40 mm)
- Max Cut - 2 3/4" (70 mm)
- Pierce Rating - 1 1/4" (32 mm)

DIMENSIONS

- 48" H x 27.5" W x 40.6" D (1219 x 698 x 1031 mm)

WEIGHT

- 490 lbs w/o torch (222 kg)
- Fully Assembled Power Supply

INPUT VOLTS

- 380-415V, 3 ph, 50/60 Hz
- 400V CE, 3 ph, 50/60 Hz
- 480V, 3 ph, 50/60 Hz

Contact Thermal Dynamics for additional information on 240V & 600V input voltage requirements.

DUTY CYCLE

- 100% @ 200 amps

AMPERAGE DRAW

- 60A @ 380V
- 57A @ 400V
- 47A @ 480V

SPECIFICATIONS

- Plasma Gas - Air, ArH₂, N₂
- Secondary Gas - Air, N₂

TORCH

- PCH200 Hand/Machine

WARRANTY

- 2 Year parts & Labor Power Supply
- 1 Year Parts & Labor Torch

APPLICATIONS INCLUDE:

- General fabrication of Carbon Steel, Stainless Steel and Aluminum
- Over the road transport trailers
- Railroad maintenance
- Vessel manufacturing
- Pipe beveling and fabrication
- Petroleum refineries
- Foundries
- Chemical plants
- Mining operations
- Ship building



TORCH CONSUMABLE PARTS

Description	Part No.	Description	Part No.
SHIELD CUPS		GAS DISTRIBUTORS	
Shield Cup, Standard	32-1325	Gas Distributor, Cutting	32-1315
Crown Shield Cup (Manual Cutting)	32-1326	Gas Distributor, Gouging	32-1509
Shield Cup (Gouging)	32-1527	ELECTRODES	
TIPS		Electrode, Air, Cutting	32-1310
Tip, 200A	32-1323	Electrode, Multi-Gas Cutting	32-1311
Tip, 150A	32-1330	Electrode, Air, Gouging	32-1504
Tip, 70A	32-1321	Electrode, ArH ₂ , Gouging	32-1505
Tip, 55A	32-1322	OTHER	
Tip, 35A	32-1320	Coolant Tube Extension, Gouging	32-1502
Tip (0.110) Gouging	32-1512	Wrench	20-0001
Tip (0.125) Gouging	32-1513	O-Ring Lubricant	8-4025
Tip (0.156) Gouging	32-1514	Parts Box	9-4173
Tip (0.171) Gouging	32-1515		

POWER SUPPLY & LEADS

Product Description	Part No.		
	480V	400V	400V CE
PAK 200i - 70° Torch / 25' (7.6 m) Leads	1-2239	1-2245	1-2251
PAK 200i - 70° Torch / 50' (15.2 m) Leads	1-2240	1-2246	1-2252
PAK 200i - 90° Torch / 25' (7.6 m) Leads	1-2241	1-2247	1-2253
PAK 200i - 90° Torch / 50' (15.2 m) Leads	1-2242	1-2248	1-2254
PAK 200i - 180° Torch / 25' (7.6 m) Leads	1-2243	1-2249	1-2255
PAK 200i - 180° Torch / 50' (15.2 m) Leads	1-2244	1-2250	1-2256

All manual systems include Power Supply, Torch and Leads, Spare Parts Kit, 25' (7.6 m) Work Cable & Clamp, and Torch Coolant.

TORCH & LEADS PACKAGES

Description	Part No.
PCH-200 / 70° / 25' (7.6 m) Leads	2-0009
PCH-200 / 70° / 50' (15.2 m) Leads	2-0010
PCH-200 / 70° / 100' (30.5 m) Leads	2-0011
PCH-200 / 90° / 25' (7.6 m) Leads	2-0012
PCH-200 / 90° / 50' (15.2 m) Leads	2-0013
PCH-200 / 90° / 100' (30.5 m) Leads	2-0014
PCM-200 / 180° / 25' (7.6 m) Leads	2-0015
PCM-200 / 180° / 50' (15.2 m) Leads	2-0016
PCM-200 / 180° / 100' (30.5 m) Leads	2-0017

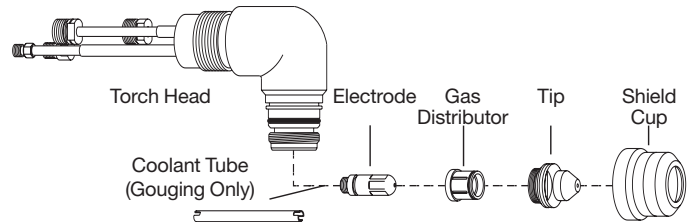

ACCESSORIES / OPTIONS

Description	Part No.
Torch Guide / Circle Cutting Attachment	7-7505
Remote Pendant Control	7-3460
Wheel Kit	9-7378